

• To Be Determined By Curb Manufacturer

**Plan View**

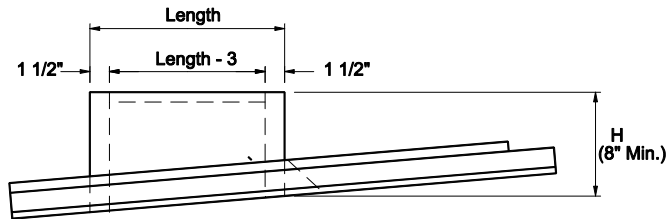

**Side View**

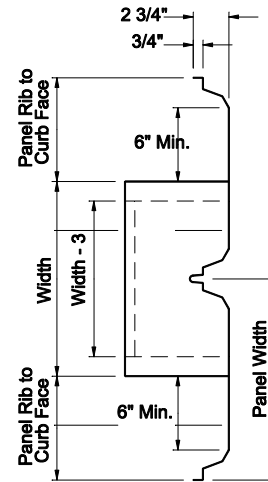

**End View**

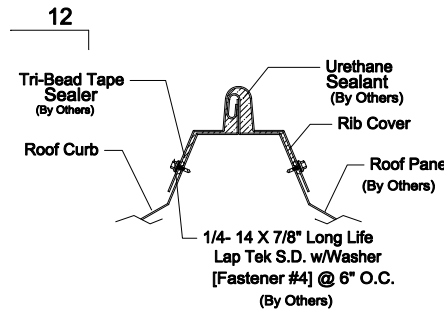

**Rib Cover Attachment**

\* Recommended for use on New Roof only

**Standard Requirements**

- \* .080 Aluminum Construction
- \* Corners Mitered and Welded Watertight
- \* Welded Cap Cells (Fixed or Loose)
- \* Integral Water Diverter
- \* 8" Minimum Curb Height
- \* 1 1/2" Thick Fiberglass Insulation
- \* Under - Over Application
- \* Rib to Rib Application
- \* Rib Covers - Full Length Plus 1'-0"
- \* 20 Year Material and Fabrication Warranty from Curb Manufacturer

**Options**

- \* Galvanized, Galvalume, Stainless Material only on non warranty curb
- \* Metal Liner
- \* Damper Shelf
- \* Decorative Enamel Finish only on non warranty curb

**MRSR-T Style may be required for trapezoidal Standing Seam Panels by following manufacturers**

- \* MBCI
- \* American Buildings
- \* A & S Building Systems
- \* Ceko Building Systems
- \* Heritage Building Systems
- \* Mesco Building Solutions
- \* Metallic Building Company
- \* Star Buildings
- \* Robertson Building Systems
- \* Steel Systems
- \* Steel Building dot Com
- \* Mid - West Steel Building Company
- \* All American Systems
- \* Garco Building Systems

Specifications and Dimensions							Roof Panel Information			 <b>ACME MANUFACTURING CORP.</b> 6532 TOWER LANE, CLAREMORE, OK 74019 Phone (918) 266-3097 Fax (918) 266-3091 <small>ENGINEERED PRODUCTS BY CRAFTSMEN</small>		
Reference	Qty	L (Pitched)	W	H	Pitch	Options	Manufacturer	Type	On Center			
											PROJECT	CONTRACTOR
											LOCATION	SUBMITTED BY
											ARCHITECT	DATE
										ENGINEER	PO#	